

REPAIR PARTS CATALOG

For Models
P-50, P-70, Also PR-50 to 65 Incl.

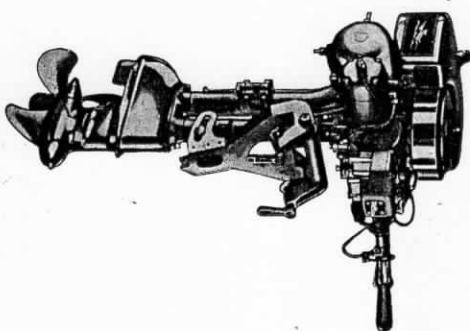

JOHNSON MOTORS
WAUKEGAN, ILLINOIS, U. S. A.

All Prices Subject to Change Without Notice

Printed in U.S.A.

7-1-58-1M-Key



How To Order Parts

1. Give MOTOR NUMBER and Model, which will be found on top of starting plate.
2. Look in list for part number which will show name and price per piece.
3. Write order plainly, giving the Motor Number, Part Number, Name of Part and Price per piece.
4. Show to whom parts are to be shipped.
5. To insure quick service ALWAYS INCLUDE REMITTANCE WITH POSTAGE TO COVER CARRYING CHARGES AND INSURANCE. Stamps are accepted as cash up to 25 cents. A minimum charge of 25 cents will be made on all orders amounting to less than that amount. All parts shipped insured at a charge of 5 cents extra.

IMPORTANT:

No replacements made unless regular claim is entered on form provided for that purpose by all authorized dealers or service stations.

ALL DEFECTIVE PARTS MUST BE RETURNED WITH CLAIM FORM PROPERLY FILLED IN, TRANSPORTATION PREPAID, before any replacements will be made.

All Prices Are Subject to Change Without Notice

Care of Motors When Used In Salt Water

Regardless of the material used in the construction of an outboard motor, it will corrode and tarnish to a certain extent when used in salt water. It is of importance, therefore, to adhere closely to the following instructions if you want to receive the most from your motor.

1. Remove the motor from the boat when it is not in service.
2. Flush out the cooling system by running motor in a barrel of fresh water.
3. Rinse off thoroughly with fresh water.
4. Wipe dry with a cloth.
5. Go over all the bright parts with an oily cloth, especially if the motor is to be stored for any length of time.

Warranty

All Johnson Motors (racing models excepted) are warranted to be free from defects in material and workmanship under normal use and service, our obligation under this Warranty being limited to making good at our factory in Waukegan, Illinois, any part or parts thereof which shall, within three months after date of delivery to owner, be returned to us with transportation charges prepaid, and which our examination shall disclose to our satisfaction to have been thus defective, this Warranty being expressly in lieu of all other warranties and representations, express or implied, and of all other liabilities in connection with the sale or use of our outboard motors.

This Warranty shall not apply to any outboard motor which shall have been repaired or altered outside of the factory in any way so as, in our judgment, to affect its stability or reliability, nor which has been subject to misuse, negligence or accident.

Claims Must Be Entered On All Returned Goods

Regular claim forms are provided all our dealers, service stations and distributors. All claims must be entered on this form, No. SE-16, before parts are returned to factory. No part will be replaced unless this form is used. See your dealer for claim form.

All material—motors or parts—be returned to your nearest service station or direct to factory TRANSPORTATION CHARGES PREPAID.

REMEMBER—ALWAYS request a claim form and properly fill it in before returning any material to our service station or direct to factory.

Warranty Does Not Apply To Racing Motors

Due to the excessive strains and stresses placed upon motors when used for racing, all Johnson motors of racing model or all other models when used for racing are sold with the distinct understanding that they are not guaranteed in any manner, and the Johnson Motor Company does not assume any responsibility for injury or damage sustained from their use thereof.

All Prices Are Subject To Change Without Notice

Always Give Part Number and Motor Number

SEA HORSE "24" POWER HEAD PARTS

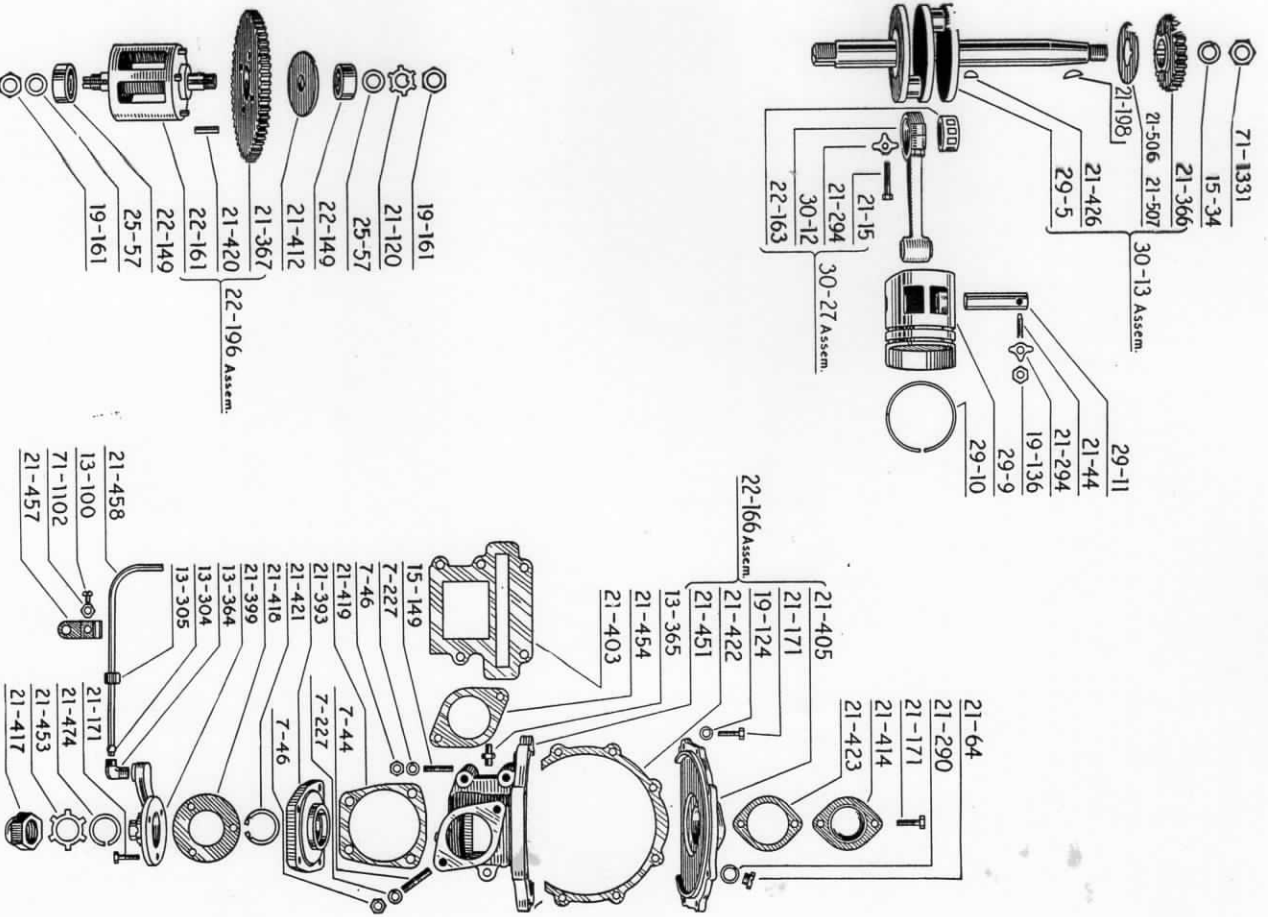

Always Give Part Number and Motor Number

SEA HORSE "24" POWER HEAD AND LOWER UNIT PARTS

Part No.	No. Required per Motor	NAME OF PART	List Price per Piece
3-40	1	Screen for Strainer.....	.05
3-41	1	Gasket for Strainer.....	.05
5-48	1	Gasket for Filler Cap.....	.05
5-58	2	Lockwasher for Driveshaft Casing to Pinion Shaft Casing Stud.....	.05
5-136	1	Lockwasher for Remote Control.....	.05
7-6	1	Screen for Oil Suction.....	.10
7-17	1	Washer for Oil Suction Screen.....	.05
7-31	2	Screw for Swivel Bracket.....	.10
7-44	2	Stud for Rotor Housing to Carburetor.....	.10
7-45	23	Nut for Cylinder Head Stud, Bypass Valve Shaft, Relief Valve Shaft, Lower Unit, Muffler to Power Head and Tank Support.....	.10
7-46	28	Nut for Crankcase Head to Crankcase, Cylinder Base Stud, Bearing Seat to Rotor Housing Stud, Rotor Housing to Crankcase Stud, Steering Handle Studs, Relief Valve and Carburetor to Rotor Housing Stud.....	.05
7-47	17	Lockwasher for Lower Unit, Muffler to Power Head, Gas Tank Screws, Tank Support Stud and Muffler Eye Studs.....	2 for .05
7-88	2	Swivel Plate for Stern Bracket Clamp Screw.....	.25
7-104	1	Washer for Thrust Socket Bolt.....	.15
7-105	1	Nut for Thrust Socket Bolt.....	.40
7-116	3	Screw for Exhaust Pipe to Muffler.....	.15
7-209	1	Lining for Thrust Socket.....	1.00
7-211	1	Tee for Crankcase Head.....	1.05
7-212	6	Elbow for Water Pipe (Order 17-138).....	.20
7-213	8	Nut for Water Pipe (Order 17-139).....	.10
7-221	2	Gland for Water Pipe (Order 7-261).....	.10
7-224	1	Plug for Crankcase Head and Crankcase Oil Holes.....	.025
7-227	31	Gasket for Magneto Cover Plate.....	.025
7-47	17	Lockwasher for Lower Unit, Muffler to Power Head, Gas Tank Screws, Tank Support Stud and Muffler Eye Studs.....	2 for .05
7-88	2	Swivel Plate for Stern Bracket Clamp Screw.....	.25
7-104	1	Washer for Thrust Socket Bolt.....	.15
7-105	1	Nut for Thrust Socket Bolt.....	.40
7-116	3	Screw for Exhaust Pipe to Muffler.....	.15
7-209	1	Lining for Thrust Socket.....	1.00
7-211	1	Tee for Crankcase Head.....	1.05
7-212	6	Elbow for Water Pipe (Order 17-138).....	.20
7-213	8	Nut for Water Pipe (Order 17-139).....	.10
7-221	2	Gland for Water Pipe (Order 7-261).....	.10
7-224	1	Plug for Crankcase Head and Crankcase Oil Holes.....	.025
7-227	31	Gasket for Magneto Cover Plate.....	.025
13-52	3	Lockwasher for Ratchet Lever Bracket Screws and Bowden Cable Lock Screws.....	2 for .05
13-100	1	Clamp Screw for Overflow Tube Clip.....	2 for .05
13-134	3	Washer for Rotor Bearing Seat Cap Screw.....	2 for .05
13-209	1	Washer for Ratchet Lever Spring.....	2 for .05
13-304	5	Gland for Oil Lines (Inlet and Return) and Overflow Tube.....	2 for .05
13-305	5	Nut for Oil Lines (Inlet and Return) and Overflow Tube.....	2 for .05
13-364	4	Elbow for Oil Lines (Inlet and Return).....	.10
13-365	1	Straight Fitting for Oil Line (Return).....	.15
13-481	2	Lockwasher for Bypass Valve Shaft and Relief Valve Shaft.....	.15
15-34	1	Lockwasher for Flywheel Nut.....	2 for .05
15-112	8	Washer for Cylinder Base Stud.....	2 for .05
15-149	14	Stud for Cylinder and Rotor Housing Cover and Bearing Seal to Rotor Housing.....	2 for .05
15-194	1	Nut for Flywheel.....	.10
15-195	2	Cotter Pin for Ratchet Lever Pin.....	2 for .05
15-197	2	Ball Joint for Bypass Valve to Relief Valve.....	2 for .05
15-213	1	Cotter Pin for Relief Valve.....	2 for .05
15-244	2	Swivel Nut for Bowden Cable.....	.15

Order All Parts from Nearest Dealer or Service Station

Order All Parts from Nearest Dealer or Service Station

Always Give Part Number and Motor Number

A HORSE "24" POWER HEAD AND LOWER UNIT PARTS—Continued

Part No.	No. Required per Motor	NAME OF PART	List Price per Piece
15-249	2	Clamp Screw for Swivel Nut.....	2 for .05
17-14	1	Bushing for Swivel Bracket.....	1.10
17-22	2	Thrust Washer Halves for Swivel Bracket.....	.20
17-30	2	Muffler Eye Nut.....	.45
17-95	4	Ferrule for Water Tube in Driveshaft Casing.....	.15
17-131	1	Gland for Gasoline Feed Pipe.....	.025
17-132	1	Nut for Gasoline Feed Pipe.....	.10
17-184	2	Stud for Swivel Bracket.....	.10
17-185	2	Nut for Swivel Bracket Stud.....	.25
17-186	2	Cotter Pin for Swivel Bracket Stud.....	2 for .05
19-51	4	Core Plug for Exhaust Pipe.....	2 for .05
19-54	2	Nut for Pinion Shaft Casing to Driveshaft Casing Stud.....	.15
19-84	1	Cotter Pin for Propeller Nut.....	21-173
19-95	1	Washer for Propeller Shaft.....	21-174
19-102	1	Pin for Propeller.....	21-177
19-124	14	Lockwasher for Rotor Housing Cover Screw, Exhaust Outout Cap and Exhaust Outout to Exhaust Pipe.....	21-178
19-136	3	Nut for Wrist Pin Lock Screws and Lock Screw on Bowden Cable.....	21-184
19-139	2	Key for Bypass Valve Lever and Relief Valve Shaft.....	21-187
19-161	4	Nut for Rotor Shaft, Pinion and Propeller Shaft.....	21-189
21-15	4	Screw for Connecting Rod.....	21-190
21-28	2	Gasket for Power Head to Lower Unit.....	21-191
21-29	1	Gasket for Crankcase Head.....	21-198
21-33	1	Bracket for Steering Handle.....	21-202
21-38	2	Nut for Hinge Pin.....	21-212
21-44	2	Screws for Locking Wrist Pin.....	21-213
21-45	3	Screws for Magneto Cover Plate.....	21-215
21-46	2	Pin for Clamp Screw.....	21-222
21-47	6	Rivet for Stern Bracket Quadrants.....	21-224
21-51	1	Bolt for Gearcase Head.....	21-230
21-55	1	Washer for Gearcase Head Bolt.....	21-290
21-56	1	Pin for Gearcase Bearing Retainer.....	21-344
21-59	1	Dowel Pin for Gearcase to Pinion Shaft Casing.....	21-342
21-62	1	Thrust Washer for Pinion Shaft.....	21-354
21-63	1	Plug for Lower Unit.....	21-355
21-64	4	Plug for Rotary Valve Inspection Hole and Gearcase Inspection Hole.....	21-356
21-65	1	Gasket for Driveshaft Casing to Pinion Shaft Casing.....	21-358
21-66	2	Water Tube for Driveshaft Casing.....	21-359
21-68	1	Stud for Driveshaft Casing to Pinion Shaft Casing.....	21-360
21-82	2	Quadrant for Stern Bracket.....	21-366
21-84	1	Bolt for Thrust Socket (Order 22-375,003).....	21-367
21-88	1	Spline Coupling.....	21-368
21-89	1	Water Tube Coupling.....	21-373
21-92	1	Clamp Screw Only for Stern Bracket.....	21-374
21-94	2	Motor Rest for Muffler.....	21-375
21-97	2	Gasket for Muffler.....	21-376
21-98	8	Stud for Muffler.....	21-377
21-99	1	Gasket for Exhaust Pipe to Muffler.....	21-378
21-101	1	Cutout Plate on Muffler.....	21-379
21-102	1	Gasket for Cutout Plate.....	21-381
21-108	1	Lever for Relief Valve.....	21-381
21-110	1	Bushing for Relief Valve.....	21-381
21-113	2	Lever for Bypass Valve and Relief Valve.....	21-393
21-114	1	Spring for Relief Valve Shaft.....	21-397
21-115	1	Cap for Bypass Valve.....	21-398
21-116	1	Bearing for Bypass Valve.....	21-399
21-117	2	Stud for Relief Valve Bracket.....	21-403
			21-404

Order All Parts from Nearest Dealer or Service Station

Always Give Part Number and Motor Number

A SEA HORSE "24" POWER HEAD AND LOWER UNIT PARTS—Continued

Part No.	No. Required per Motor	NAME OF PART	List Price per Piece
21-118	2	Stud for Muffler Eye Nut.....	21-118
21-120	4	Lock Washer for Rotor Shaft Nut, Pinion and Propeller Shaft Nut.....	21-120
21-121	1	Washer for Gearcase Inspection Hole Plug.....	21-121
21-122	4	Clamp Screw for Lower Unit Plug.....	21-122
21-152	2	Handle Hinge.....	21-152
21-153	8	Stud for Cylinder Head.....	21-153
21-154	8	Washer for Cylinder Head Stud.....	21-154
21-163	1	Cotter Pin for Ratchet Lever Stud.....	21-163
21-165	1	Washer for Relief Valve.....	21-165
21-170	2	Stud for Crankcase Head to Crankcase (Short).....	21-170
21-171	11	Screw for Rotor Housing Cover and Upper and Lower Bearing Caps to Rotor Housing.....	21-171
21-173	1	Pin for Spline Coupling.....	21-173
21-174	3	Welch Core Plug for Muffler (Small).....	21-174
21-177	1	Pin for Ratchet Lever.....	21-177
21-178	1	Spring for Ratchet Lever.....	21-178
21-184	4	Rivet for Finger and Ratchet Lever.....	21-184
21-187	4	Stud for Crankcase Head to Crankcase (Long).....	21-187
21-189	2	Stud for Power Head to Lower Unit.....	21-189
21-190	4	Gasket for Bypass Valve Cap.....	21-190
21-191	2	Dowel Pin for Cylinder Head.....	21-191
21-192	1	Spacer for Gas Tank Support.....	21-192
21-198	1	Key for Crankshaft.....	21-198
21-202	2	Screw for Gas Tank to Cylinder.....	21-202
21-212	1	Spring for Bypass Valve.....	21-212
21-213	1	Washer for Bypass Valve.....	21-213
21-215	3	Stud for Steering Handle to Cylinder.....	21-215
21-222	1	Spring for Relief Valve.....	21-222
21-224	1	Stud for Tank Support.....	21-224
21-230	2	Welch Core Plug for Muffler (Large).....	21-230
21-290	1	Washer for Rotor Valve Inspection Hole Plug.....	21-290
21-294	6	Lock Plate for Piston Pin Screw and Connecting Rod Screws.....	21-294
21-344	1	Nut for Tithing Shaft.....	21-344
21-342	2	Handle for Stern Bracket Clamp Screw.....	21-342
21-354	1	Bracket for Relief Valve.....	21-354
21-355	1	Bushing for Relief Valve Bracket.....	21-355
21-356	1	Shaft for Relief Valve.....	21-356
21-358	4	Screw for Exhaust Outout to Exhaust Pipe.....	21-358
21-359	2	Screw for Exhaust Outout Cap.....	21-359
21-360	1	Groove Pin for Relief Valve.....	21-360
21-366	1	Gear for Crankshaft.....	21-366
21-367	1	Gear for Rotor.....	21-367
21-368	1	Tube for Steering Handle.....	21-368
21-373	1	Spring for Stop Switch.....	21-373
21-374	1	Cap for Steering Handle.....	21-374
21-375	1	Grip for Steering Handle.....	21-375
21-376	1	Hinge Pin for Steering Handle.....	21-376
21-377	1	Control Handle.....	21-377
21-378	1	Hinge for Steering Handle.....	21-378
21-379	1	Washer for Stop Button Return.....	21-379
21-380	1	Thrust Washer for Steering Handle Cap.....	21-380
21-381	2	Tube for Control Handle.....	21-381
21-393	1	Bearing Seat for Rotor Housing.....	21-393
21-396	1	Bracket for Ratchet Lever.....	21-396
21-397	1	Nut for Ratchet Lever.....	21-397
21-398	1	Stud for Ratchet Lever Stud.....	21-398
21-399	1	Cap for Rotor Bearing Seat.....	21-399
21-403	1	Gasket for Rotor Housing to Crankcase.....	21-403
21-404	1	Shaft for Rotor.....	21-404

Order All Parts from Nearest Dealer or Service Station

EA HORSE "24" POWER HEAD AND LOWER UNIT PARTS—Continued

SEA HORSE "24" POWER HEAD AND LOWER UNIT PARTS—Continue

Part No.	No. Required per Motor	NAME OF PART	List Price per Piece
21-410	1 to 4	Shims for Rotor Housing to Crankcase (.006).....	.05
21-411	1 to 4	Shims for Rotor Housing to Crankcase (.015).....	.10
21-412	1	Cap for Rotor Bearing.....	1.30
21-413	1	Bushing for Rotor Ball Bearing (Obsolete).....	1.20
21-414	1	Cap for Rotor Ball Bearing.....	1.00
21-417	1	Nut for Rotor Bearing Cap.....	.75
21-418	1	Gasket for Rotor Bearing Cap to Rotor Bearing Seat.....	.10
21-419	2	Gasket for Rotor Bearing Seat to Rotor Housing.....	.05
21-420	4	Drive Pin for Rotor.....	.15
21-421	1	Ring for Lower Rotor Bearing.....	.10
21-422	1	Gasket for Rotor Housing Cover.....	.10
21-423	1	Gasket for Rotor Housing Cap.....	.10
21-424	1	Stud for Rotor Housing to Crankcase.....	.10
21-426	3	Key for Crankshaft Gear.....	.10
21-428	1	Attachment Plug Body.....	.75
21-431	1	Journal Bearing (Lower).....	2.50
21-432	1	Journal Bearing (Upper).....	3.00
21-433	1	Crankcase Head Only.....	9.25
21-434	1	Oil Slinger for Crankshaft.....	.55
21-435	1	Cover Plate for Magneto.....	4.50
21-448	2	Washer for Stern Bracket.....	.15
21-453	1	Lockwasher for Rotor Bearing Cap Nut.....	.10
21-454	1	Gasket for Carburetor to Rotor Housing (Order 21-535).....	.10
21-457	1	Clip to Overflow Tube.....	.20
21-458	1	Overflow Tube.....	.25
21-461	1	Clamp for Bowden Cable.....	.15
21-474	1	Spring Washer for Rotor Bearing (Lower).....	.15
21-475	1	Nut for Driveshaft Casing to Pinion Shaft Casing.....	.15
21-483	1	Clamp for Throttle Bowden Wire to Carburetor.....	.15
21-484	1	Clip for Choke Bowden Control.....	.05
21-490	1	Clip for Bowden Cable to D. S. Casing.....	.15
21-491	1	Screw for Choke Bowden Wire Clip.....	.05
21-502	1	Lockscrew for Bowden Cable.....	.25
21-506	1 to 4	Shim for Gear to Crankshaft (.005).....	.10
21-507	1 to 4	Shim for Gear to Crankshaft (.010).....	.05
23-17	1 to 4	Shim for Bevel Pinion (.002).....	.05
23-28	1	Propeller (12x15) (Obsolete).....	16.50
23-42	1	Bevel Pinion (Order 30-375543).....	9.50
23-43	1	Bevel Gear (Order No. 30-375543).....	9.50
23-46	1	Pinion Shaft.....	8.25
23-52	1	Bearing for Propeller Shaft (Propeller End).....	.75
23-53	1	Nut for Propeller.....	.90
23-54	1	Gasket for Gearcase Head.....	.10
23-57	2	Studs for Gearcase to Driveshaft Casing (Extra Long).....	2.25
23-58	1	Gasket for Gearcase to Pinion Shaft Casing.....	.05
23-61	1	Bearing for Pinion Shaft (Upper).....	.90
23-63	1	Handle for Relief Valve.....	1.00
23-84	1	Washer for Bevel Pinion.....	.05
23-87	1	Retainer for Propeller Thrust Bearing.....	2.25
23-89	1	Propeller Shaft (Order 30-375,083).....	7.50
23-90	1	Screw for Adjusting Gears.....	2.75
23-91	1	Gearcase Head.....	2.00
23-91	1	Shim for Bevel Pinion.....	.05
23-162	1	Key for Bevel Gear.....	.10
23-172	1	Clamp Screw for Bowden Cable Clip.....	2 for .05
25-74	1	Crankshaft (Less Gear).....	42.00
29-5	1	Pistons.....	7.25
29-9	2	Piston Ring.....	.30
29-10	4	Piston Pin.....	.85
29-11	2	Bushing for Wrist Pin.....	.60
29-12	2	Bypass Valve.....	4.00
29-13	1	Bypass Valve.....	4.00

Part No.	No. Required per Motor	NAME OF PART	List Price per Piece
29-14	2	Gasket for Cylinder Head (Order 29-51).....	.60
29-15	2	Gasket for Cylinder Base.....	.05
29-16	1	Relief Valve.....	1.00
29-17	1	Transfer Gas Tank (Order 29-151).....	Net 20
29-21	1	Rod for Bypass Valve to Relief Valve.....	.10
29-24	1	Exhaust Outout Body.....	2.00
29-25	1	Plunger for Exhaust Outout.....	1.25
29-26	1	Retaining Ring for Exhaust Outout Plunger.....	.15
29-27	1	Cap for Exhaust Outout.....	.30
29-28	1	Gasket for Exhaust Outout Cap.....	.05
29-29	1	Spring for Outout Plunger.....	.10
29-30	1	Gasket for Exhaust Outout to Exhaust Pipe.....	.05
29-33	1	Cylinder Head—Star.....	8.75
29-44	1	Cylinder Head—Port.....	10.00
51-47	2	Screw for Ratchet Lever Bracket.....	.05
71-765	1	Screw for Ground Wire to Steering Handle.....	2 for .05
71-870	1	Insulation Plug for Cutout Lead on Steering Handle.....	.25
71-872	2	Rubber Washer for Insulation Plug on Steering Handle.....	.05
71-1102	1	Nut for Bowden Cable Clamp Screw and Overflow Tube Clip Screw.....	.05
85-63	4	Screw for Cutout Plate.....	2 for .05
85-64	4	Check Nut for Ball Joint.....	2 for .05
8-35	1	Thrust Socket Assembly.....	3.75
16-19	1	Starting Cord.....	.25
22-15	1	Driveshaft Assembly.....	9.75
22-17	1	Driveshaft Casing Assembly.....	25.50
22-44	1	Shut Off Valve and Screen Assembly.....	1.80
22-65	1	Stern Bracket with Quadrants Only.....	18.25
22-78	1	Swivel Bracket Assembly Complete.....	12.00
22-92	1	Water Tube Assembly—Outlet—Starboard.....	.75
22-93	1	Water Tube Assembly—Outlet—Port.....	.75
22-137	1	Relief Valve Lever and Shaft Assembly.....	7.50
22-139	1	Stern Bracket Handle and Shaft Assembly.....	1.50
22-140	2	Push Button Assembly.....	1.20
22-141	1	Contact Block and Lead.....	.70
22-142	1	Contact Block and Lead Assembly Complete.....	1.50
22-145	1	Ratchet Lever and Finger Assembly.....	1.00
22-149	1	Ball Bearing for Rotor Shaft.....	1.70
22-160	2	Steering Handle Complete.....	25.50
22-161	1	Rotor and Shaft Assembly (Less Gear).....	10.50
22-163	2	Roller Bearing Assembly for Connecting Rod.....	5.50
22-165	1	Tilting Shaft Assembly.....	5.50
22-169	1	Bowden Cable Assembly.....	1.70
22-195	1	Rotary Valve and Housing Assembly Complete.....	69.00
22-196	1	Rotor and Shaft Assembly with Gear.....	21.00
22-201	1	Oil Line Assembly (Inlet).....	.55
22-202	1	Oil Line Assembly (Return).....	.55
22-203	1	Feed Line Complete.....	.35
22-204	1	Relief Valve Assembly.....	2.25
22-205	1	Crankcase Head and Bearing Assembly.....	12.75
24-22	1	Pinion Shaft Casing Assembly (Less Pinion Shaft and Gear) (Bearings Reamed).....	12.25
24-37	1	Shipping Crate for P50 Model (Obsolete).....	45.00
30-112	1	Rotor Housing and Cover (Obsolete).....	33.00
31-19	1	Filler Cap Assembly.....	1.50

Order All Parts from Nearest Dealer or Service Station

Order All Parts from Nearest Dealer or Service Station

Always Give Part Number and Motor Number

SEA HORSE "24" LOWER UNIT PARTS

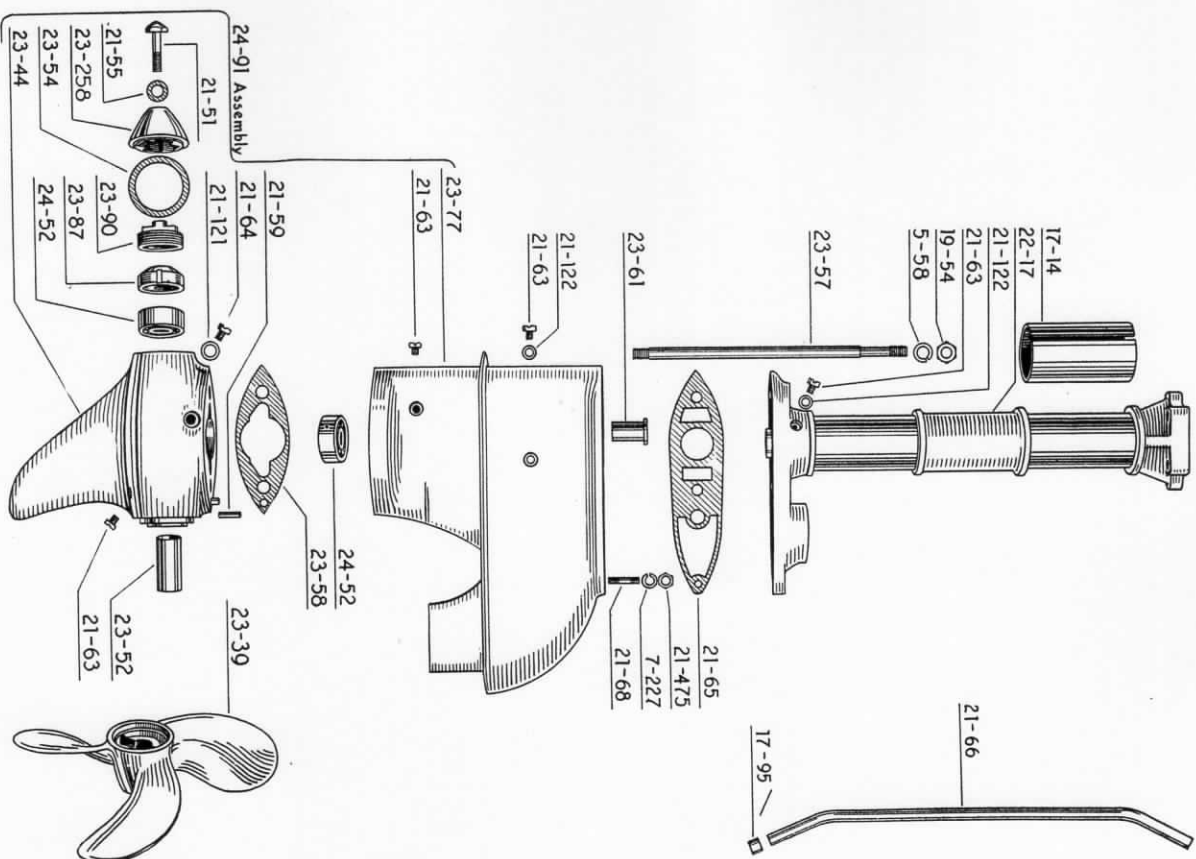

Order All Parts from Nearest Dealer or Service Station

Always Give Part Number and Motor Number

SEA HORSE "24" LOWER UNIT PARTS

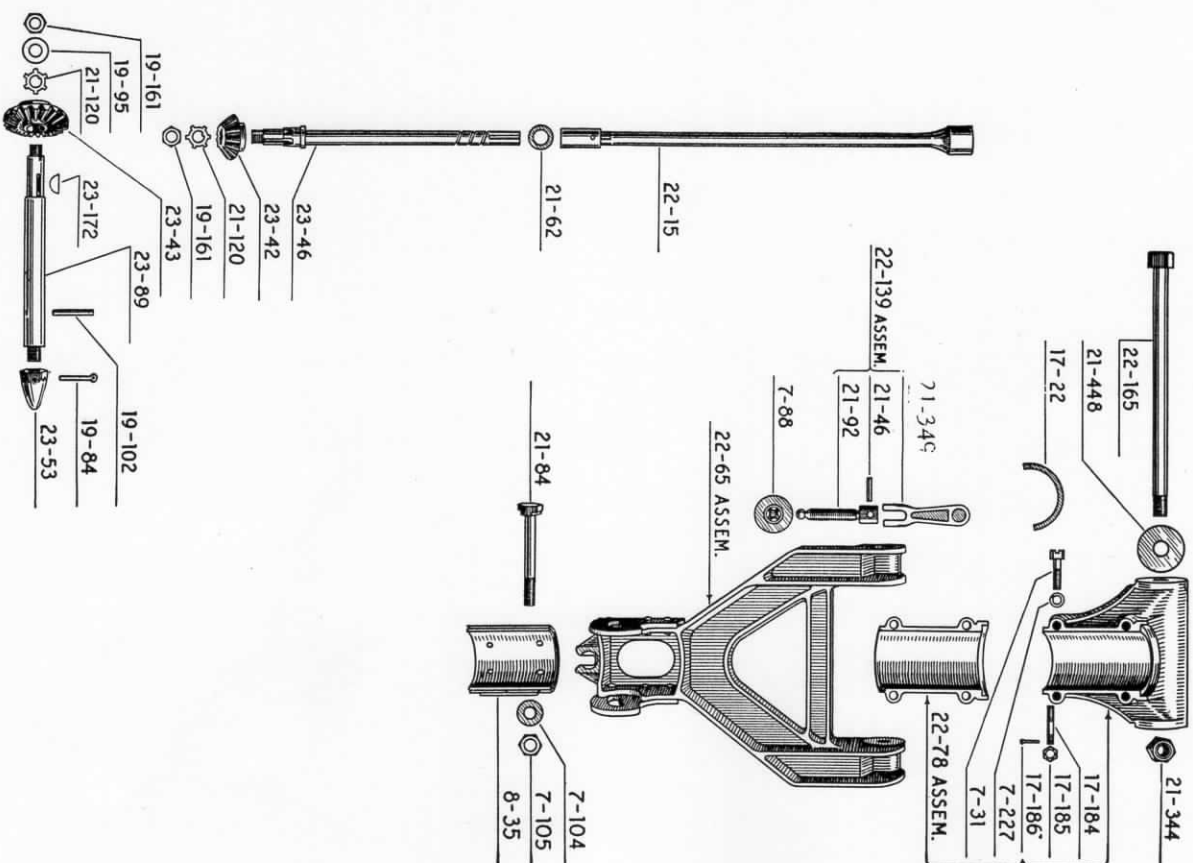

Order All Parts from Nearest Dealer or Service Station

Always Give Part Number and Motor Number

SEA HORSE "24" MAGNETO PARTS—Continued

Part No.	No. Required per Motor	NAME OF PART	List Price per Piece
71-939	4	Screw for Mounting Coil to Plate.....	2 for .05
71-940	2	Screw for Heels.....	2 for .05
71-1048	1	Washer for Breaker Post.....	2 for .05
71-1052	1	Clip Spring for Breaker Post.....	2 for .05
71-1054	3	Drive Screw for Mounting Cam.....	2 for .05
71-1126	1	Cam.....	1.00
71-1128	1	Breaker Post.....	.15
71-1139	1	Timing Lever Casting.....	1.50
71-1219	2	Bushing for High Tension Lead.....	1.50
71-1220	2	Clamp for High Tension Lead.....	1.50
71-1223	1	Quadrant.....	.50
71-1229	2	Terminal for Ignition Lead.....	1.00
71-1235	1	Screw for Armature Plate Clamp.....	.10
71-1240	1	Terminal for Breaker.....	.10
71-1261	1	Clip for Cutout Lead.....	.05
71-1274	1	Clip for Cutout Lead Armature.....	.05
71-1268	1	Locknut for Contact Screw.....	.05
71-1369	1	Felt Pad for Condenser Pocket.....	2 for .05
SEA HORSE "24" MAGNETO ASSEMBLIES			
72-736	1	Breaker Arm and Spring Assembly.....	.95
72-781	1	Breaker Plate and Point Assembly.....	.55
72-851	1	Coil Assembly (with Heels).....	10.50
72-852	1	Coil Assembly (Less Heels).....	8.50
72-855	1	Heel Assembly—Right Hand.....	.75
72-856	1	Heel Assembly—Left Hand.....	.75
72-858	1	Armature Plate and Clamp Screw Only.....	6.00
72-859	1	Armature Plate Assembly Complete.....	27.00
72-860	1	Magneto Complete.....	66.00
72-861	1	Done Assembly.....	39.00
72-864	1	Condenser Complete.....	2.00
72-879	1	Ignition Lead.....	.70
72-883	2	Cutout Lead Assembly.....	1.00

PARTS FOR PR-50 MOTOR THAT ARE DIFFERENT FROM THOSE USED FOR P-50

7-92	1	Pin for Propeller.....	.25
7-211	2	Elbow for Exhaust Pipe (Use 17-138).....	.20
7-261	1	Gland for Gasoline Feed Pipe.....	.10
13-432	2	Pipe for Water Pipe in Pinion Shaft Casing.....	.15
13-542	1	Pipe Plug for Exhaust Pipe.....	.10
15-107	2	Lockwasher for Gearcase to Pinion Shaft Casing Stud.....	.05
21-47	6	Rivet for Quadrant to Stern Bracket.....	.05
21-52	1	Bushing for Propeller Shaft.....	1.45
21-53	1	Propeller Nut.....	1.00
21-54	1	Gasket for Gearcase Head.....	2.20
21-57	2	Stud for Gearcase to Driveshaft Casing.....	1.10
21-58	1	Gasket for Gearcase to Pinion Shaft Casing.....	1.50
21-61	1	Bearing for Pinion Shaft (Upper).....	8.25
21-78	1	Pinion Shaft.....	.85
21-87	1	Retainer for Propeller Thrust Bearing.....	.90
21-90	1	Bearing Locknut.....	2.40
21-91	1	Gearcase Head.....	.90
21-91	1	Key for Bevel Gear.....	.10
21-172	1	Cotter Pin for Propeller Nut.....	.05
21-219	2	Quadrant for Stern Bracket (Obsolete).....	.90
21-264	1	Gasket for Driveshaft Casing to Pinion Shaft Casing.....	1.10
21-269	1	Bevel Pinion.....	5.25
21-270	1	Bevel Gear.....	8.00
21-271	1	Exhaust Pipe (Obsolete).....	7.50
21-303	1	Exhaust Pipe (Obsolete).....	7.50

Order All Parts from Nearest Dealer or Service Station

Always Give Part Number and Motor Number

PARTS FOR PR-50 MOTOR THAT ARE DIFFERENT FROM THOSE USED FOR P-50—Continued

Part No.	No. Required per Motor	NAME OF PART	List Price per Piece
21-427	1	Propeller Shaft.....	6.00
21-515	1	Gear for Crankshaft.....	6.00
21-516	1	Gear for Rotor.....	12.75
23-29	1	Propeller (Obsolete).....	9.00
23-75	1	Nut for Gasoline Feed Line.....	1.15
29-82	1	Piston (for Racing Only).....	5.50
29-83	1	Cylinder Head (Star).....	5.50
29-84	1	Cylinder Head (Port).....	5.50
29-85	1	Piston Ring (Order 29-10).....	.30
29-51	2	Gasket for Cylinder Head.....	.60
ASSEMBLIES FOR PR-50 MOTOR			
22-52	2	Ball Bearing for Pinion and Propeller Shafts.....	3.45
22-59	1	Driveshaft Assembly.....	6.75
22-60	1	Driveshaft Casing Assembly.....	24.00
22-90	1	Water Tube Assembly—Star—Inlet.....	.60
22-91	1	Water Tube Assembly—Port—Outlet.....	.60
22-98	1	Stern Bracket Complete (Obsolete).....	24.00
22-212	1	Stern Bracket with Quadrants (Obsolete).....	22.50
24-44	1	Shut Off Valve and Screen Assembly (Obsolete).....	2.25
24-63	1	Pinion Shaft Casing Assembly (with Bearings Reamed (Obsolete).....	37.75
24-67	1	Gearcase and Pinion Case Assembly Only (Obsolete).....	60.50
24-139	1	Gearcase with Propeller Shaft, Bevel Gear, Bearings, etc. (Less Pinion Case) (Obsolete).....	37.50
30-28	2	Piston and Connecting Rod with Bearings.....	17.25
30-29	2	Crankshaft and Gear Assembly.....	45.00
30-34	1	Gasoline Feed Pipe and Settling Basin.....	1.35
30-36	1	Bowden Cable Assembly (Obsolete).....	.40
76-179	2	Spark Plug (Racing Only).....	.50

CARBURETOR PARTS FOR PR-50 MOTOR

1-13	6	Screw for Valve Cover, Control Lever Clamp and Control Lever Stops.....	2 for .05
1-104	1	Nut for Control Lever Stop Screws.....	2 for .05
1-107	1	Float Cover.....	1.90
1-108	1	Drain Nut.....	.80
1-110	1	Nozzle.....	.55
1-111	1	Throttle Valve.....	3.25
1-112	1	Stuffing Nut.....	.25
1-114	1	Disc for Barrel Valve.....	1.15
1-116	2	Gasket for Needle Valve Housing.....	.15
1-117	1	Spring for Float Cover.....	.70
1-118	1	Float for Carburetor (Obsolete).....	.65
1-121	1	Gasket for Carburetor to Adapter.....	.05
1-122	1	Screen for Settling Basin.....	2 for .10
1-132	1	Gasket for Settling Basin Plug.....	.025
1-133	1	Gasket for Settling Basin.....	2 for .05
1-135	5	Hot Air Pipe (Obsolete).....	4.45
1-140	2	Screw for Needle Valve Casting.....	.05
1-141	1	Key for Throttle Valve.....	.05
1-141	3	Screw for Hot Air Pipe.....	2 for .05
3-15	1	Screw for Carburetor Clean Out.....	2 for .05
3-15	1	Cotter Pin for Float.....	2 for .05

Order All Parts from Nearest Dealer or Service Station

Always Give Part Number and Motor Number
IGNITION PARTS FOR PE-50 AND PA-50 ELECTRIC STARTING MOTOR
TO BE PURCHASED FROM JOHNSON MOTORS—Continued

Part No.	No. Required per Motor	NAME OF PART	List Price per Piece
71-49	2	Washer for Bracket Screws.....	2 for .05
71-66	1	Insulation Washer.....	2 for .05
71-67	1	Insulation Plate.....	2 for .05
71-939	1	Screw for Starter Switch Bracket Handle.....	2 for .05
71-1038	2	Screw for Breaker Switch to Breaker Swivel Plate.....	2 for .05
71-1046	1	Cam Block (Obsolete).....	.05
71-1048	1	Bracket for Breaker (Obsolete).....	2 for .05
71-1072	1	Washer for Breaker Post.....	2 for .05
71-1074	2	Clip for Breaker Post.....	2 for .05
71-1075	1	Screw for Breaker Mounting.....	1.0
71-1283	1	Nut for Bar.....	10.20
71-1287	1	Bridge for Breaker (Obsolete).....	1.35
71-1288	1	Cam (Obsolete).....	2.55
71-1289	1	Breaker Swivel Plate (Obsolete).....	.60
71-1290	1	Swivel Post (Obsolete).....	.05
71-1291	1	Pin for Swivel Post (Obsolete).....	.05
71-1292	2	Clip for Bowden Wire (Obsolete).....	2 for .05
71-1295	1	Spring Clip for Breaker Plate (Obsolete).....	.05
71-1296	2	Terminal for Primary Wire (Obsolete).....	.55
71-1297	2	Terminal for Safety Gap.....	.05
71-1303	6	Screw for Breaker and Bridge to Field Frame (Obsolete).....	2 for .05
71-1304	2	Screw for Breaker Plate Spring (Obsolete).....	.05
71-1305	1	Block for Swivel Post (Obsolete).....	1.00
71-1310	4	Rivet (Obsolete).....	2 for .05
71-1311	1	Can Screw for Field Frame to Crankcase.....	.05
71-1313	3	Coil (Obsolete).....	21.00
71-1316	1	Grommet-Rubber—for Ignition Leads.....	.05
71-1317	1	Support for Coil (Obsolete).....	6.75
71-1318	1	Tube for Coil Mounting (Obsolete).....	4.65
71-1319	1	Strap for Coil Mounting (Obsolete).....	.43
71-1320	1	Cap for Coil Mounting Tube—Port (Obsolete).....	2.45
71-1321	1	Cap for Coil Mounting Tube—Star (Obsolete).....	2.10
71-1322	1	Felt Pad (Obsolete).....	2 for .25
71-1323	1	Strap for Condenser (Obsolete).....	.25
71-1325	6	Screw for Coil Support to Field Frame and Coil Mounting Strap.....	.05
71-1331	1	Nut for Crankshaft (Obsolete).....	.05
71-1335	2	Drive Screw for Swivel Post Block (Obsolete).....	2 for .05
71-1337	2	Nut for High Tension Lead to Coil (Obsolete).....	2 for .05
71-1340	1	Handle for Starter Switch Bracket (Obsolete).....	.25
71-1341	1	Nut for Starter Switch Bracket Handle Screw (Obsolete).....	2 for .05
71-1346	1	Bolt Puller (Obsolete).....	1.00
71-1349	1	Cam Post (Obsolete).....	1.50
71-1350	1	Nut Puller (Obsolete).....	2.70
71-1352	6	Screw for Rope Pulley to Armature (Obsolete).....	2 for .05
85-64	4	Nut for Starter Switch to Bracket Stud.....	2 for .05
91-373	7	Screw for Primary and Bowden Wire Clip and Bowden Wire for Swivel Post and Bowden Cable Clips.....	2 for .05
91-423	1	Washer for Breaker Plate Screw—Inner.....	.025
ASSEMBLIES FOR PE-50 AND PA-50 MOTORS			
22-184	1	Cable for Battery to Ground (Obsolete).....	7.85
22-185	1	Cable for Starter to Switch (Obsolete).....	7.50
22-186	1	Cable for Battery Positive to Switch (Obsolete).....	3.75
22-187	1	Cable for Starter Generator to Switch (Obsolete).....	3.75
24-112	1	Control Cable Assembly—Spark (Obsolete).....	9.30
72-738	1	Upper Base Plate Assembly.....	1.20
72-739	1	Starter Switch (Obsolete).....	6.00
72-896	1	Cover Assembly (Obsolete).....	4.30
72-902	1	Starter Switch Bracket Assembly (Obsolete).....	.90
72-903	1	Screw for Coil Mounting Tube Clamps (Obsolete).....	1.20

Order All Parts from Nearest Dealer or Service Station

Always Give Part Number and Motor Number
ASSEMBLIES FOR PE-50 AND PA-50 MOTORS—Continued

Part No.	No. Required per Motor	NAME OF PART	List Price per Piece
72-910	2	Lead Assembly for Breaker to Coil (Obsolete).....	.30
72-911	1	Lead Assembly for Starter Switch to Coil (Obsolete).....	.55
72-913	2	High Tension Lead (Obsolete).....	.75
72-916	1	Breaker Assembly.....	3.15
72-931	1	Condenser and Strap Assembly (Order 72-905) (Obsolete).....	3.00
72-937	1	Breaker Swivel Plate and Post Assembly (Obsolete).....	5.35

Part No.	No. Required per Motor	NAME OF PART	List Price per Piece
5-136	1	Lockwasher for Choke Bowden Control Clip Screw.....	2 for .05
11-45	2	Cotter Pins for Anchor Swivel Nut.....	.05
21-482	1	Plate—Cylinder Steering Handle Pad.....	1.35
21-483	1	Clamp for Bowden Cable on Carburetor.....	.15
21-484	1	Clip for Choke Bowden Control.....	.05
21-490	1	Clip for Bowden Cable to Driveshaft Casing.....	.15
21-491	1	Screw for Choke Bowden Control Clip.....	.05
22-183	1	Settling Basin and Fitting Assembly (Obsolete).....	1.55
29-31	1	Transfer (Order 29-151 Transfer).....	Net 20
71-1308	2	Swivel Nut for Choke and Throttle.....	.15

PARTS FOR 1932 P-50 AND PE-50 MOTORS THAT ARE DIFFERENT FROM THOSE USED IN 1931

Part No.	No. Required per Motor	NAME OF PART	List Price per Piece
13-136	1	Bushing.....	.15
15-197	1	Ball Joint for Carburetor Lever.....	.25
21-158	2	Washer for Spacer to Rotary Valve Bearing.....	2 for .05
21-454	1	Gasket for Carburetor to Adapter (Order 21-535).....	.10
21-535	1	Gasket for Carburetor to Rotor Housing.....	.10
21-535	1	Strap Fitting.....	.30
21-534	1	Adapter—Plate—Carburetor (PE-50 Motor Only).....	1.80
22-234	1	Rotor Housing and Cover.....	11.50
22-249	1	Vacuum Carburetor.....	27.75
29-69	1	Gas Line Assembly (PE-50 Motor Only).....	1.15
30-63	1	Control Handle.....	2.50
35-30	1	Spring for Control Handle.....	.30
35-32	1	Washer for Control Handle.....	.10
35-33	1	Ball Joint for Control Handle Spring.....	.45
35-34	1	Rod for Carburetor Control Assemblies.....	.30
36-12	1	Bushing and Rotor Ball Bearing Assembly.....	8.65
76-122	1	Electric Solenoid Switch (Electric Starting Motors Only) (Obsolete).....	6.00

PARTS FOR PR-55 MOTOR THAT ARE DIFFERENT FROM THOSE USED ON P-50 AND PR-50

Part No.	No. Required per Motor	NAME OF PART	List Price per Piece
7-49	1	Washer for Screw 23-261.....	2 for .05
7-261	2	Gland for Gasoline Feed Pipe.....	10
13-229	1	Washer for Propeller Shaft.....	.55
13-542	1	Pipe Plug for Exhaust Pipe—Housing Cover.....	.10

Order All Parts from Nearest Dealer or Service Station

Always Give Part Number and Motor Number

PARTS FOR PR-55 MOTOR THAT ARE DIFFERENT FROM THOSE USED ON P-50 AND PR-50—Continued

Part No.	No. Required per Motor	NAME OF PART	List Price per Piece
17-139	1	Nut for Gasoline Feed Pipe—Carburetor End	.10
21-158	2	Washer—Spacer to Bearing	2 for .05
21-284	2	Pipe Plug—Cylinder Head	.10
21-535	1	Gasket—Carburetor to Rotor Housing	.10
21-536	1	Washer—Behind Bevel Gear	.55
25-57	2	Washer—Rotor Shaft Nut	2 for .05
29-56	2	Piston	5.50
29-59	1	Bypass Valve (Obsolete)	2.25
29-60	4	Piston Ring	.30
29-65	2	Gasket for Cylinder Base	.05
29-66	2	Cylinder Head	5.00
35-18	1	Ring—Lower Journal Bearing	2.25
35-19	1	Seal Ring—Lower Journal Bearing	.90
35-21	1	Oil Slinger—Crankshaft	1.05
35-22	1	Oil Seal—Upper Bearing	1.90
35-25	1	Bearing Race	5.50
35-28	1	Bearing Race	5.00
35-31	1	Spring for Control Handle	30
35-32	1	Washer for Control Handle Spring	10
35-33	1	Ball Joint for Control Handle	.45
35-34	1	Rod for Carburetor Control	.30
35-42	1	Bevel Pinion (Order 21-270)	5.25
35-43	1	Bevel Gear (Order 21-271)	8.00
35-47	1	Spacer Washer—Lower Journal	.75
35-48	1	Pinion Shaft	5.25
35-50	1	Straight Fitting for Carburetor (Use 31-128)	1.05
51-115	8	Lockwasher—Cylinder Base Stud	2 for .05
MOTOR ASSEMBLIES			
22-99	1	Gearcase and Head Assembly (Bearings Reamed) (Obsolete)	16.50
22-143	1	Steering Handle and Tube Assembly	2.75
22-233	1	Rotor and Shaft	6.75
22-234	1	Rotor Housing and Cover Assembly	11.50
22-238	1	Crankcase Head and Bearing Cage Assembly	12.75
22-243	1	Gasoline Feed Line Complete	.75
22-244	1	Rotor Valve Assembly Complete	60.00
22-245	1	Rotor and Shaft Assembly (With Gear)	17.25
22-246	1	Oil Line Assembly—Return	.40
24-65	1	Gearcase and Pinion Shaft Casing Complete, Gears, Propeller Shaft, Pinion Shaft (Obsolete) and Gasoline Tank Complete With Shut-off Valve and Filler Cap (Obsolete)	105.00
30-19	1	Crankshaft and Gear Assembly	40.50
30-49	1	Crankcase, Crankshaft and All Bearings Complete	45.00
30-53	1	Crankcase with All Bearings Complete	112.50
30-54	1	Piston and Connecting Rod with Bearings	75.00
30-55	2	Cylinder Assembly—Star	20.25
30-58	2	Cylinder Assembly—Port	16.50
30-59	1	Thrust Bearing—Lower Journal	16.50
36-9	1	Vacuum Carburetor Assembly	4.95
36-10	1	Bushing and Ball Bearing Assembly—Rotor Shaft	30.00
36-12	1	Rotor Cover and Bearing Assembly	8.65
36-21	1	Swivel Bracket Assembly Complete	14.25
36-28	1	Swivel Bracket Assembly Complete	13.15
36-37	1	Connecting Rod Complete with Bearings	25.95
36-41	2	Screw for Armature Plate Clamp	16.50
71-1381	1	Armature Plate and Clamp Screw Only	.10
72-950	1	Magneto Complete	3.85
72-952	1	Armature Plate Assembly Complete	75.00
72-957	1		22.50

Order All Parts from Nearest Dealer or Service Station

Always Give Part Number and Motor Number

PARTS FOR PR-60 RACING MOTOR Motor Parts for PR-60

Part No.	No. Required per Motor	NAME OF PART	List Price per Piece
5-48	1	Gasket for Filler Cap	.05
5-58	2	Lockwasher for Gearcase to Driveshaft Casing Stud	.05
5-136	1	Lockwasher for Bowden Clamp Screw	2 for .05
7-6	1	Screen for Crankcase	.10
7-17	2	Ring for Crankcase and Relief Valve Screen	.05
7-14	2	Stud for Rotor Housing to Carburetor	.10
7-45	22	Nut for Cylinder Head Stud, Lower Unit and Muffler to Power Head and Gas Tank Stud	.05
7-46	26	Nut for Crankcase Head to Crankcase, Steering Handle and Carburetor to Rotor Housing	2 for .05
7-47	19	Lockwasher for Lower Unit and Muffler to Power Head, Muffler Eye Nut, Tank Support Studs, Tank Screws and Muffler	2 for .05
7-88	2	Swivel Plate for Ball Wing Screws	.25
7-99	1	Lockwasher for Flywheel Nut	.05
7-100	4	Dowel Pin for Piston	.025
7-104	1	Washer for Thrust Socket Bolt	.15
7-105	1	Nut for Thrust Socket Bolt	.40
7-123	1	Liming for Thrust Socket	1.00
7-209	1	Tee for Crankcase Head (Order 7-258)	.55
7-211	8	Nut for Water Pipe and Exhaust (Order 17-1389)	.20
7-212	10	Nut for Water Pipe (Order 17-1389)	.10
7-213	10	Gland for Water Pipe (Order 7-261)	.10
7-221	1	Plug	2 for .05
7-222	1	Gasket for Cover Plate	.025
7-224	1	Lockwasher for Crankcase Head Studs, Bearing Seat to Rotor Housing, Rotor Housing to Crankcase, Steering Handle and Carburetor Rotor Housing	2 for .05
7-227	18	Gland for Gasoline Feed Pipe	2 for .05
7-261	2	Lockwasher for Hinge Lockscrew, Ratchet Lever and Bracket Screw	2 for .05
13-52	3	Clamp Screw for Overflow Tube Clip	2 for .05
13-100	1	Washer for Rotor Bearing Seat Capscrew	2 for .05
13-134	3	Gland for Oil Lines and Overflow Tube	2 for .05
13-209	1	Nut for Oil Lines and Overflow Tube	2 for .05
13-304	5	Elbow for Oil Lines and Overflow Tube	.10
13-305	5	Core Plug for Exhaust Casting	.15
13-364	6	Pipe Plug for Housing Cover and Skeg	.05
13-426	1	Stud for Cylinder and Rotor Cover to Crankcase and Bearing Seat to Rotor Housing	10
15-149	14	Cutter Pin for Ratchet Lever Pin	2 for .05
15-195	2	Ball Joint for Carburetor Lever	.25
15-197	1	Swivel Nut	.15
15-244	1	Screw for Swivel Nut	2 for .05
15-249	1	Bushing for Swivel Bracket	1.10
17-14	1	Thrust Washer Halves for Swivel Bracket	20
17-22	2	Eye Nut for Muffler	.45
17-30	4	Rivet for Thrust Socket Linning	2 for .05
17-72	4	Nut for Feed Line, Carburetor End	.10
17-139	1	Stud for Swivel Bracket	1.0
17-184	4	Cutter Pin for Swivel Bracket Stud	.25
17-185	4	Lockwasher for 15-197	2 for .05
17-186	4	Nut—Gearcase to Driveshaft Casing Stud	2 for .05
17-212	1	Locking Screw for Exhaust Casting to Shell	2 for .05
19-54	2	Lockwasher for Housing Cover Screw and Locking Screw	2 for .05
19-123	7	Nut for Rotor Shaft and Ball Bearing	2 for .05
19-124	1		
19-161	3		

Order All Parts from Nearest Dealer or Service Station

Always Give Part Number and Motor Number

PARTS FOR PR-60 RACING MOTOR—Continued

Part No.	No. Required per Motor	NAME OF PART	List Price per Piece
21-13	52	Roller for Upper and Lower Journal Bearing.....	.15
21-15	4	Screw for Connecting Rod.....	.25
21-28	1	Gasket for Crankcase Head to Lower Unit.....	.10
21-29	1	Gasket for Crankcase Head.....	.05
21-33	1	Bracket for Steering Handle.....	5.00
21-38	2	Nut for Hinge Pin.....	.15
21-39	1	Washer for Hinge Pin Nut.....	.05
21-53	1	Nut for Propeller.....	1.00
21-63	2	Plug for Lower Unit.....	.20
21-64	1	Plug for Inspection Hole in Rotor.....	.30
21-84	1	Bolt for Thrust Socket (Order 22-315,003).....	1.25
21-88	1	Spline Coupling for Driveshaft.....	1.85
21-98	8	Stud for Muffler.....	.10
21-118	2	Stud for Steering Bar.....	.10
21-120	3	Lockwasher for Rotor Shaft Nut.....	.05
21-122	2	Washer for 21-63.....	.05
21-132	1	Clamp Screw for Hinge.....	.15
21-134	8	Washer for Cylinder Head Stud.....	.05
21-158	2	Washer for Spacer to Bearing.....	.05
21-153	2	Cotter Pin for Ratchet Lever Stud.....	.05
21-163	2	Stud for Crankcase Head to Crankcase—Short.....	.10
21-170	2	Stud for Crankcase Head to Crankcase—Long.....	.10
21-171	7	Screw for Upper Bearing Cap and Cover and Cap to Seat.....	.05
21-173	1	Pin for Spline Coupling.....	.05
21-177	1	Pin for Ratchet Lever.....	.15
21-178	1	Spring for Ratchet Lever.....	.10
21-187	1	Stud for Crankcase Head to Crankcase—Long.....	.10
21-189	4	Stud for Power Head to Lower Unit.....	.15
21-191	2	Dowel Pin for Cylinder Head.....	.05
21-198	2	Key for Crankshaft.....	.15
21-202	2	Support Bracket to Exhaust Casting.....	.05
21-215	3	Stud for Steering Handle to Cylinder.....	.10
21-219	1	Cotter Pin for Propeller Nut.....	.05
21-224	1	Stud for Deflector to Tank Support.....	.10
21-269	1	Gasket for Driveshaft Casting to Gearcase.....	.10
21-284	2	Pipe Plug for Cylinder Head.....	.10
21-290	1	Washer for Inspection Hole Plug.....	.05
21-293	1	Socket Wrench.....	1.15
21-294	4	Lockplates for Connecting Rod Screw.....	.15
21-295	2	Dowel Pin for Upper Rotor Bearing.....	.05
21-344	1	Nut for Tilting Shaft.....	1.15
21-373	1	Spring for Stop Switch.....	.05
21-374	1	Cap for Steering Handle.....	.30
21-376	1	Hinge Pin for Steering Handle.....	1.70
21-378	1	Washer for Stop Button Return.....	6.00
21-379	1	Cap Washer for Steering Handle.....	.05
21-380	1	Thrust Washer for Hinge Pin.....	2 for .05
21-381	2	Tube for Control Handle.....	.40
21-391	1	Bearing Seat for Rotor Housing.....	5.75
21-393	1	Bracket for Ratchet Lever.....	.10
21-396	1	Stud for Ratchet Lever.....	.15
21-397	1	Nut for Ratchet Lever Stud.....	.05
21-398	1	Cap for Rotor Bearing Seal.....	4.50
21-399	1	Gasket for Rotor Housing to Crankcase.....	.05
21-403	1	Shim for Rotor Housing to Crankcase.....	.05
21-410	1 to 3	Shim for Rotor Housing to Crankcase.....	.10
21-411	1 to 3	Spacer for Rotor Bearing.....	1.30
21-412	1	Cap for Rotor Bearing.....	.75
21-417	1	Nut for Rotor Bearing.....	1.00
21-418	1	Gasket for Rotor Bearing Seal to Housing.....	.10
21-419	1	Drive Pin for Rotor.....	.05
21-420	4	Gasket for Rotor Housing Cover.....	.15
21-422	1	Gasket for Rotor Bearing Cap.....	.10
21-423	1	Gasket for Rotor Housing to Crankcase.....	.10
21-424	3	Stud for Rotor Housing to Crankcase.....	.10

Order All Parts from Nearest Dealer or Service Station

Always Give Part Number and Motor Number

PARTS FOR PR-60 RACING MOTOR—Continued

Part No.	No. Required per Motor	NAME OF PART	List Price per Piece
21-426	1	Key for Crankshaft Gear.....	1.0
21-428	1	Attachment Plug Body.....	.75
21-448	2	Washer for Stern Bracket.....	.15
21-453	1	Lockwasher for 21-417.....	.10
21-457	1	Clip for Overflow Tube.....	.20
21-458	1	Overflow Tube.....	.25
21-469	2	Spacer for Muffler Eye Nut.....	.10
21-476	1	Handle for Socket Wrench.....	.15
21-484	1	Clamp for Bowden Wire.....	.05
21-491	1	Screw for 21-484.....	.05
21-516	1	Gear for Rotor.....	12.75
21-535	1	Gasket for Carburetor to Rotor Housing.....	.10
23-75	1	Nut for Gas Line—Tank End.....	.15
23-94	2	Motor Rest for Muffler.....	1.85
25-57	2	Washer for Rotor Shaft Nut.....	.05
27-132	2	Gasket for Gearcase Head and Cooke Seal.....	.60
29-12	2	Bushing for Wrist Pin.....	.05
29-17	1	Transfer for Gas Tank (Order 29-151).....	Net .20
29-45	2	Gasket for Cylinder Base.....	.05
29-70	1	Bushing for Keilwell Valve Fire Screen (Obsolete).....	.85
29-76	1	Propeller 9x14.....	15.80
29-81	1	Cylinder Head.....	6.00
29-82	2	Muffler Shell.....	.60
29-84	2	Spacer to Raise Gas Tank.....	.60
29-85	2	Bearing Race—Upper.....	7.50
29-86	10	Stud for Cylinder Head and to Raise Tank.....	.25
29-87	4	Plug for Wrist Pin (Order 29-197).....	1.15
29-88	2	Wrist Pin (Use 29-197).....	1.15
29-89	4	Retainer for Upper Journal.....	2.40
29-90	1	Oil Seal for Upper Journal.....	2.75
29-91	1	Gear for Crankshaft.....	6.00
29-92	1	Nut for Flywheel.....	2.25
29-93	1	Piston Ring.....	2.25
29-94	4	Oil Slinger for Crankshaft.....	.40
29-95	1	Gasket for Muffler.....	1.50
29-96	1	Shim for Crankshaft .002.....	.30
29-97	1	Shim for Crankshaft .005.....	.15
29-98	1 to 3	Support for Gas Tank to Muffler.....	1.0
29-99	1	Gasket for Gearcase to Skeg.....	1.05
29-101	1	Pinion Gear and Shaft.....	1.10
29-102	1	Bevel Gear.....	17.25
29-103	1	Skeg for Gearcase.....	14.25
29-104	1	Propeller Shaft.....	4.25
29-105	1	Needle Bearing for Propeller Shaft.....	9.00
29-106	46	Spacer for Propeller Shaft.....	1.0
29-109	1	Pilot Sleeve for Gearcase.....	.70
29-110	1	Shear Pin for Propeller.....	.75
29-111	1	Shim for Propeller Shaft.....	1.0
29-113	1	Retainer for Cooke Seal.....	.60
29-114	1	Spacer for Spline Coupling.....	2.25
29-115	2	Stud for Gearcase to Driveshaft Casting.....	.25
29-116	1	Bearing Race for Propeller Shaft.....	4.0
29-118	1	Cap for Gearcase.....	4.00
29-122	1	Pipe Plug for Exhaust Casting 1/4 Inch.....	1.30
29-123	2	Screw for Upper Bearing Race.....	.55
29-126	1	Screw for Skeg to Gearcase.....	.30
29-129	3	Shut Off Valve for Gas Tank.....	.40
29-130	1	Washer for Skeg Plate Screw.....	3.50
29-131	3	Gasket for Cylinder Head.....	.05
29-141	2	Retainer for Conn Rod Rollers.....	1.50
29-142	10	Rollers for Conn Rod.....	.90
33-47	1	Screen for Relief Valve.....	1.0
35-17	1	Retainer for Lower Journal.....	.10
35-18	4	Ring for Lower Journal.....	.70
			2.25

Order All Parts from Nearest Dealer or Service Station

Always Give Part Number and Motor Number

PARTS FOR PR-60 RACING MOTOR—Continued

Part No.	No. Required per Motor	NAME OF PART	List Price per Piece
35-19	1	Seal Ring for Lower Journal	.90
35-30	1	Control Handle	2.50
35-31	1	Spring for Control Handle	.30
35-32	1	Washer for Control Handle Spring	.10
35-33	1	Ball Joint for Control Handle	.45
35-34	1	Rod for Carburetor Control	.30
35-47	1	Spacer Washer for Lower Journal	.75
35-50	1	Straight Fitting for Carburetor (Order 31-128)	1.05
51-47	2	Screw for Ratchet Lever Bracket	.05
51-115	8	Lockwasher for Cylinder Base Stud	2 for .05
71-765	1	Screw for Ground Wire to Handle	2 for .25
71-870	1	H. T. Plug for Handle	.25
71-872	1	Rubber Washer for Handle	.05
71-1102	1	Nut for Overflow Tube Clip Screw	2 for .05
85-64	1	Jam Nut for Carburetor Control Rod	2 for .05
85-114	2	Dowel Pin for Gearcase to Driveshaft Casing	2 for .05
201-114	1	Nut for Gas Tank Support Bracket Stud (Obsolete)	.60

MOTOR ASSEMBLIES

8-35	1	Thrust Socket Assembly	3.75
14-140	1	Tool Bag Only	.30
16-19	1	Starting Cord	.25
22-52	2	Ball Bearing for Pinion and Propeller Shaft—Lower	3.45
22-59	1	Driveshaft	6.75
22-60	1	Driveshaft Casing	2.00
22-139	1	Clamp Screw Assembly	1.50
22-140	2	Push Button Assembly	1.50
22-142	1	Contact Block and Lead	1.50
22-143	1	Grip and Tube Assembly	2.75
22-145	1	Ratchet Lever and Finger Assembly	1.00
22-146	1	Ball Bearing for Rotor Shaft	1.70
22-165	1	Timing Shaft Assembly	1.70
22-215	1	Stern Bracket with Quadrant (Obsolete)	22.50
22-215	1	Rotor Housing and Cover	11.50
22-234	1	Shipping Crate (Obsolete)	11.50
24-37	1	Relief Valve Fire Screen Assembly (Obsolete)	1.05
30-62	1	Connecting Rod Assembly	9.75
30-64	2	Lower Unit Less Propeller (Obsolete)	200.00
30-68	1	Crankcase, Seal and Bearing Race Assembly	30.00
30-69	1	Roller and Retainer Assembly (Obsolete)	5.50
30-70	2	Crankshaft and Gear	45.00
30-71	1	Rotor and Shaft Only	7.50
30-72	1	Exhaust Casting—Port (Obsolete)	35.00
30-73	1	Exhaust Casting—Star (Obsolete)	35.00
30-74	1	Exhaust Deflector	11.50
30-75	1	Street Elbow and Screen Assembly	6.00
30-76	1	Cookie Seal Assembly	2.50
30-77	1	Gearcase Assembly Complete	142.50
30-81	1	Rotary Valve Complete	60.00
30-82	1	Water Tube—Inlet—Star and Port	.60
30-83	1	Cylinder Assembly—Port	18.00
30-84	1	Cylinder Assembly—Star	18.00
30-85	1	Crankcase Complete	75.00
30-86	1	Piston and Connecting Rod Assembly	30.00
30-87	2	Water Tube—Outlet—Star	.75
30-88	1	Water Tube—Outlet—Port	1.15
30-89	1	Gasoline Feed Pipe	1.20
30-90	1	Tool Kit Complete (Obsolete)	12.50
30-91	1	Gas Tank Complete (Obsolete)	40.00
30-92	1	Gas Tank only with Transfer (Obsolete)	40.00
30-93	1	Water Tube Assembly—Outlet—Muffler	42.00
30-94	2	Muffler Assembly Complete	.45
30-95	1	Crankcase and Crankshaft Assembly Complete	90.00
30-96	1	Gearcase Assembly with Bearings	125.00
30-97	1		75.00

Always Give Part Number and Motor Number

PARTS FOR PR-60 RACING MOTOR—Continued

Part No.	No. Required per Motor	NAME OF PART	List Price per Piece
30-99	2	Piston and Dowel Pin	7.75
30-101	2	Connecting Rod Assembly with Bearings	15.00
30-102	1	Rotor and Shaft Assembly with Gear	22.50
34-19	1	Filler Cap Assembly	1.50
36-9	1	Thrust Bearing for Lower Journal	4.95
36-10	1	Carburetor Complete	30.00
36-11	1	Crankcase Head and Bearing Race Assembly	10.50
36-12	1	Bushing and Ball Bearing for Rotor Shaft	8.65
36-28	1	Swivel Bracket Assembly	13.15
36-37	1	Steering Handle Complete	25.95
76-130	1	Spark Plugs—R-11	.90
202-13	2	Ball Bearing for Upper Pinion Shaft (Obsolete)	3.15

MAGNETO PARTS FOR PR-60

1-20	5	Screw for Condenser Mounting and Ground	2 for .05
3-27	8	Lockwasher for Condenser and Timing Lever Mounting	2 for .05
3-28	3	Lockwasher for Quadrant Screw	2 for .05
5-114	7	Screw for Timing Lever and High Tension Mounting	2 for .05
71-31	1	Screw for Breaker Mounting	.05
71-45	1	Screw for Spring Mounting	2 for .05
71-49	1	Washer for Contact Screw	2 for .05
71-60	1	Terminal for Cutout Lead	2 for .05
71-66	2	Insulation Washer	2 for .05
71-471	2	Nut for Screw 71-45 and Contact Screw	.025
71-610	3	Washer for Breaker Mounting Screw	.05
71-765	1	Screw for Quadrant	2 for .05
71-783	4	Insulation Tubing	.05
71-914	1	Shakeproof Lockwasher	2 for .05
71-1048	1	Washer for Breaker Post	2 for .05
71-1052	1	Bushing for Breaker Arm	2 for .05
71-1128	1	Spring Chip for Breaker Post	2 for .05
71-1139	1	Breaker Post	.15
71-1146	1	Timing Lever	1.50
71-1219	1	Contact Screw	.20
71-1220	2	Bushing for H. T. Lead	.15
71-1223	1	Clamp for H. T. Lead	.15
71-1240	1	Quadrant	.50
71-1261	1	Terminal for Breaker	.10
71-1268	1	Chip for Cutout Lead	2 for .05
71-1274	1	Locknut for Contact Screw	.05
71-1369	1	Felt Pad for Condenser Pocket	2 for .05

MAGNETO ASSEMBLIES

72-736	1	Breaker Arm and Spring	.95
72-781	1	Breaker Plate and Point	.55
72-851	1	Coil Assembly with Heels	10.50
72-852	1	Coil Assembly Less Heels	8.50
72-855	1	Heel Assembly—Right	.75
72-856	1	Heel Assembly—Left	.75
72-879	2	Condenser Complete	2.00
72-883	1	High Tension Lead	.70
72-885	1	Outout Lead Assembly	1.00
72-967	1	Dome Assembly	52.50
72-975	1	Armature Plate and Clamp Screw	5.25
72-976	1	Magneto Complete	75.00
72-977	1	Armature Plate Complete	22.50

NOTE: All Carburetor Parts should be purchased from the R. F. Bracke & Co., 5462 Elston Avenue, Chicago, Illinois.

Order All Parts from Nearest Dealer or Service Station

Order All Parts from Nearest Dealer or Service Station

Always Give Part Number and Motor Number

PARTS FOR P-65 MOTOR

All other parts not listed here are same as those used on P-50 model.

Part No.	No. Required per Motor	NAME OF PART	List Price per Piece
3-27	2	Lockwasher for Gas Gauge Screw.....	.025
25-176	1	Cap for Gas Gauge.....	.55
25-177	1	Base for Gas Gauge.....	.60
25-180	2	Screw for Gas Gauge.....	.30
25-181	2	Gasket for 25-182 Tube.....	.05
25-182	1	Tube for Gas Gauge.....	1.75
25-183	2	Gasket for 25-176 and 25-177.....	.05
25-184	4	Washer for Gauge to Tank Screw.....	.025
29-140	1	Transfer for Gas Tank (Order 29-151).....	Net .20
30-109	1	Gas Tank with Transfer (Order 30-121).....	31.00
30-110	1	Gas Tank Complete (Obsolete).....	53.00
71-1352	4	Screw for Gauge to Tank (Obsolete).....	.025

PARTS FOR P-70 MOTOR THAT DIFFER FROM THOSE USED ON MODELS P-65 AND P-50

Part No.	No. Required per Motor	NAME OF PART	List Price per Piece
7-258	1	Tee for Crankcase Head.....	.55
7-261	8	Gland for Water Pipe.....	.10
17-138	6	Elbow for Water Pipe.....	.20
17-139	8	Nut for Water Pipe.....	.10
21-276	3	Screw for Steering Handle to Cylinder.....	.05
21-594	1	Starting Instructions for Gas Tank.....	N/C
21-595	1	Oiling Instructions for Gas Tank.....	N/C
21-601	2	Screw for Swivel Bracket.....	.10
21-602	1	Transfer for Gas Tank (Order 29-151).....	Net .20
23-282	1	Cap Packing for Propeller Shaft Bushing.....	.10
23-283	1	Cap for Propeller Shaft Bushing (Order 30-375428).....	.40
23-284	1	Bushing for Propeller Shaft.....	1.50
71-1420	2	Grommet for Ignition Cable.....	.05
ASSEMBLIES			
22-280	1	Crankcase Head and Bearing Assembly (Order 22-375,119).....	12.25
22-281	1	Gas Tank with Transfer (Obsolete).....	39.50
30-112	1	Rotor Housing, Cover and Bushing Assembly (Obsolete).....	33.00

All Model P-50, P-65, P-70, P-75, P-80 and PO-37 Motors using
Vacturi Carburetor order parts direct from Bracke Carburetor Co.,
5462 Elston Ave., Chicago, Illinois.

Order All Parts from Nearest Dealer or Service Station